

說明 NOTES

此圖根據第 SCL-G27 號 (修改) 圖則訂制, 以粉紅色標明將永久封閉的暢運道路段。

THIS DRAWING IS PREPARED BASED ON DRAWING NO. SCL-G27 (REVISION 1) AND IS INTENDED TO SHOW THE PERMANENT CLOSURE OF A SECTION OF CHEONG WAN ROAD (HIGHLIGHTED IN PINK).

**圖例 LEGEND**

- 方案界線
- 擬建的鐵路車站及其他鐵路設施(地下)
- 擬建的車站 / 車站入口 / 過風大樓 / 通風井 / 其他鐵路設施或永久建築物
- 現有的車站及其他鐵路設施
- 擬建用鑽孔或掘地法開挖的鐵路設施(地下)
- 擬建用明挖或掘地法開挖的鐵路設施(地下)
- 可永久封閉的道路(包括行車道、行人徑及露天地方) WHICH MAY BE CLOSED PERMANENTLY
- 擬設置地盤的臨時工作區
- 擬於政府前地或海濱地段或政府土地(非為形成土地)或其他工程(可能在其上進行填海工程(非為形成土地)或其他工程) PROPOSED TEMPORARY WORKS AREA FOR SITE FACILITIES ON GOVERNMENT FORESHORE OR SEABED (OTHER THAN FOR FORMING LAND) OR OTHER WORKS MAY BE CARRIED OUT
- 擬建的行人天橋 / 扶手电梯 / 升降機 / 樓梯
- 擬建的有蓋行人通道
- 擬於政府前地或海濱地段或政府土地(非為形成土地)或其他工程(可能在其上進行填海工程(非為形成土地)或其他工程) PROPOSED RAILWAY FACILITIES/TUNNEL (INCLUDING PROTECTION LAYER/PROCK ARMOUR) BY IMMERSED TUBE METHOD ON GOVERNMENT FORESHORE OR SEABED (OTHER THAN FOR FORMING LAND) OR OTHER WORKS MAY BE CARRIED OUT
- 擬於政府前地或海濱地段或政府土地(非為形成土地)或其他工程(可能在其上進行填海工程(非為形成土地)或其他工程) PROPOSED RAILWAY FACILITIES/TUNNEL (INCLUDING PROTECTION LAYER/PROCK ARMOUR) BY IMMERSED TUBE METHOD ON GOVERNMENT FORESHORE OR SEABED (OTHER THAN FOR FORMING LAND) OR OTHER WORKS MAY BE CARRIED OUT
- 擬建的鐵路設施(地下)
- 擬建於沙田中環及另一項正在發展的鐵路項目(下列「另一項鐵路項目」包括的範圍(地下) / 車站 / 車站大堂 / 車站入口 / 過風大樓 / 通風井 / 其他鐵路設施或永久建築物(下列「設施」) / 擬於政府前地或海濱地段或政府土地(非為形成土地)或其他工程(可能在其上進行填海工程(非為形成土地)或其他工程)) PROPOSED RAILWAY FACILITIES/TUNNEL (INCLUDING PROTECTION LAYER/PROCK ARMOUR) BY IMMERSED TUBE METHOD ON GOVERNMENT FORESHORE OR SEABED (OTHER THAN FOR FORMING LAND) OR OTHER WORKS MAY BE CARRIED OUT
- 受影響的政府前地或海濱地段的大約範圍
- 圖則修改
- 修訂參考編號(參閱憲報公告)
- 修訂範圍

一般說明 GENERAL NOTES  
1. 有關一般說明參閱圖號 SCL-G01.  
FOR GENERAL NOTES, REFER TO DRAWING NO. SCL-G01.

修訂表  
TABLE OF AMENDMENTS

修訂號	日期	修訂人	修訂理由	說明	
REV	DATE	BY	SUB	APP	DESCRIPTION

SIGNED  
 9/4/2015  
 發出日期 DATE OF ISSUE

圖則名稱 DRAWING TITLE  
**鐵路條例(第519章)**  
**沙田至中環線**  
**永久封閉暢運道路段**

RAILWAYS ORDINANCE (CHAPTER 519)  
 SHATIN TO CENTRAL LINK  
 PERMANENT CLOSURE OF A SECTION OF CHEONG WAN ROAD

圖號 DRAWING NO.  
**SCL/G27/0032/3**  
 比例 SCALE  
 1:1000 (A1)  
 或顯示  
 OR AS SHOWN

香港特別行政區政府  
 THE GOVERNMENT OF THE HONG KONG  
 SPECIAL ADMINISTRATIVE REGION  
**路政署**  
 HIGHWAYS DEPARTMENT  
**鐵路拓展處**  
 RAILWAY DEVELOPMENT OFFICE

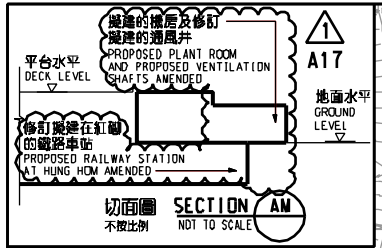
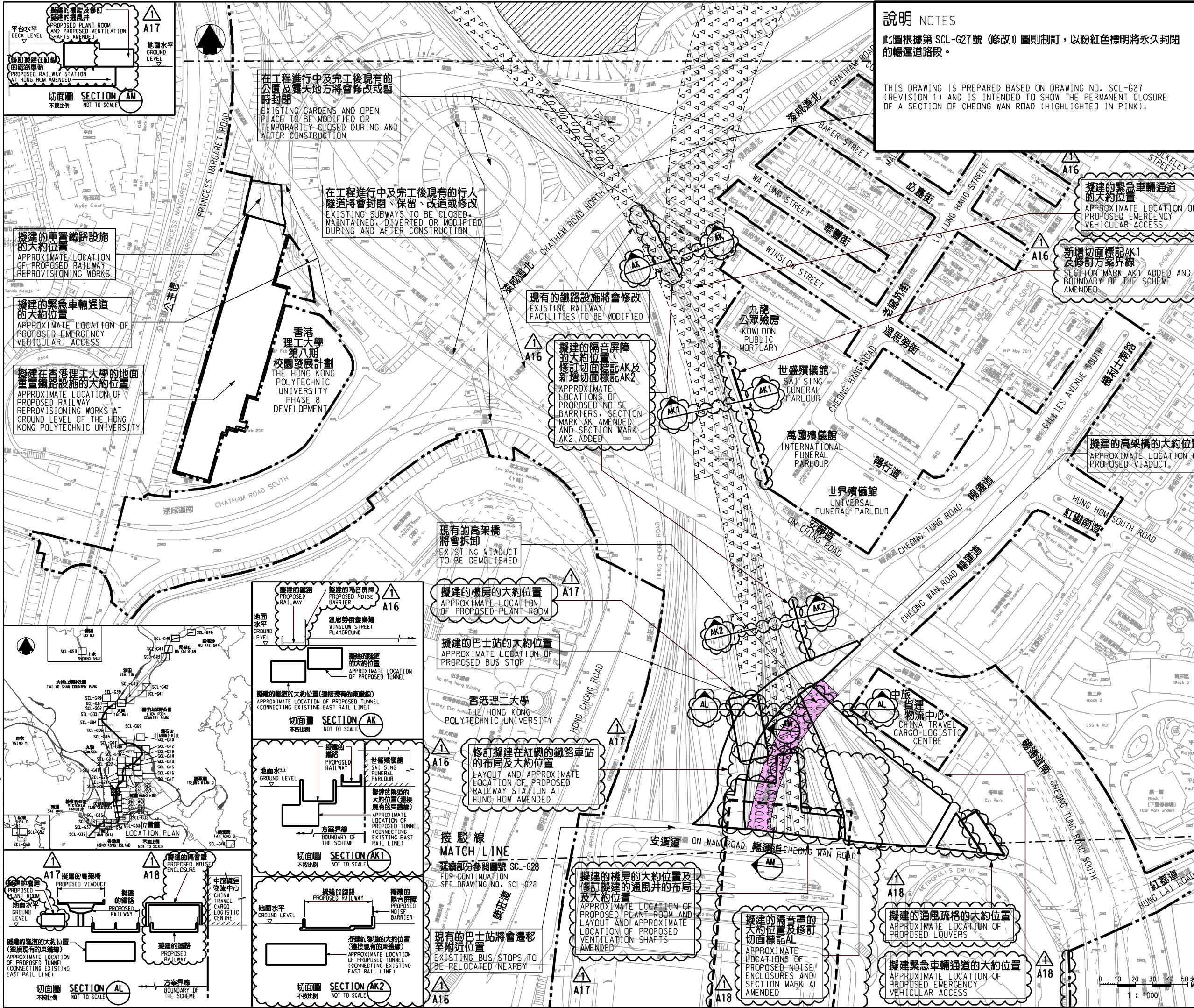

在工程進行中及完工後現有的公園及露天地方將會修改或暫時封閉  
EXISTING GARDENS AND OPEN PLACE TO BE MODIFIED OR TEMPORARILY CLOSED DURING AND AFTER CONSTRUCTION

在工程進行中及完工後現有的行人隧道將會封閉、保留、改道或修改  
EXISTING SUBWAYS TO BE CLOSED, MAINTAINED, DIVERTED OR MODIFIED DURING AND AFTER CONSTRUCTION

擬建的單層鐵路設施的大約位置  
APPROXIMATE LOCATION OF PROPOSED RAILWAY REPROVISIONING WORKS

擬建的緊急車輛通道的大約位置  
APPROXIMATE LOCATION OF PROPOSED EMERGENCY VEHICULAR ACCESS

擬建在香港理工大學的地面單層鐵路設施的大約位置  
APPROXIMATE LOCATION OF PROPOSED RAILWAY REPROVISIONING WORKS AT GROUND LEVEL OF THE HONG KONG POLYTECHNIC UNIVERSITY

香港理工大學  
第八期  
校園發展計劃  
THE HONG KONG POLYTECHNIC UNIVERSITY  
PHASE 8 DEVELOPMENT

現有的鐵路設施將會修改  
EXISTING RAILWAY FACILITIES TO BE MODIFIED

擬建的隔音屏障的大約位置、修訂切面標記AK及新增切面標記AK2  
APPROXIMATE LOCATIONS OF PROPOSED NOISE BARRIERS, SECTION MARK AK AMENDED AND SECTION MARK AK2 ADDED

現有的高架橋將會拆卸  
EXISTING VIADUCT TO BE DEMOLISHED

擬建的機房的大約位置  
APPROXIMATE LOCATION OF PROPOSED PLANT ROOM

擬建的巴士站的大約位置  
APPROXIMATE LOCATION OF PROPOSED BUS STOP

香港理工大學  
THE HONG KONG POLYTECHNIC UNIVERSITY

修訂擬建在紅欄的鐵路車站的布局及大約位置  
LAYOUT AND APPROXIMATE LOCATION OF PROPOSED RAILWAY STATION AT HUNG HOM AMENDED

接駁線  
MATCH LINE  
延續部分參閱圖號 SCL-G28  
FOR CONTINUATION SEE DRAWING NO. SCL-G28

擬建的機房的大約位置及修訂擬建的通風井的布局及大約位置  
APPROXIMATE LOCATION OF PROPOSED PLANT ROOM AND LAYOUT AND APPROXIMATE LOCATION OF PROPOSED VENTILATION SHAFTS AMENDED

擬建的隔音屏障的大約位置及修訂切面標記AL  
APPROXIMATE LOCATIONS OF PROPOSED NOISE ENCLOSURES AND SECTION MARK AL AMENDED

擬建的通風隔格的大約位置  
APPROXIMATE LOCATION OF PROPOSED LOUVERS

擬建緊急車輛通道的大約位置  
APPROXIMATE LOCATION OF PROPOSED EMERGENCY VEHICULAR ACCESS

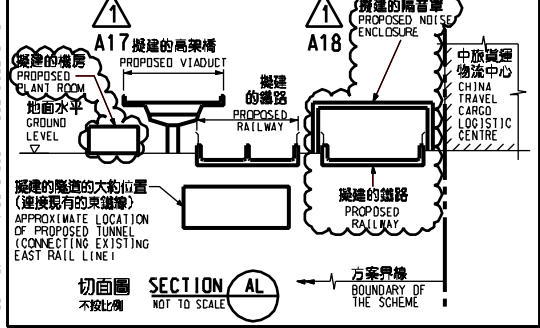
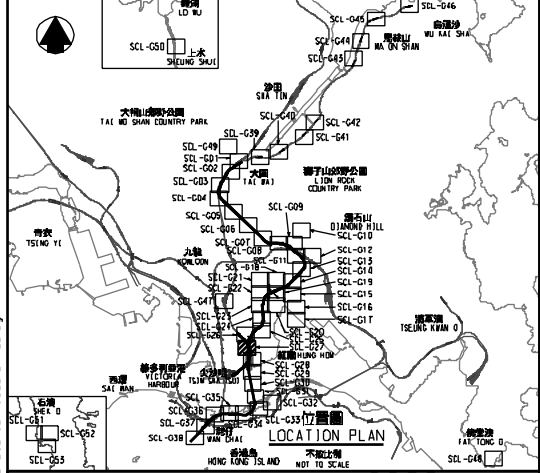

Plot: 137047205  
 File: SCL-G27/0032/3-3-001.dwg  
 Date: 13/04/2015  
 User: ftkko  
 Plot Date: 13/04/2015  
 Plot File: SCL-G27/0032/3-3-001.dwg